

# INSTALLATION & MAINTENANCE INSTRUCTIONS

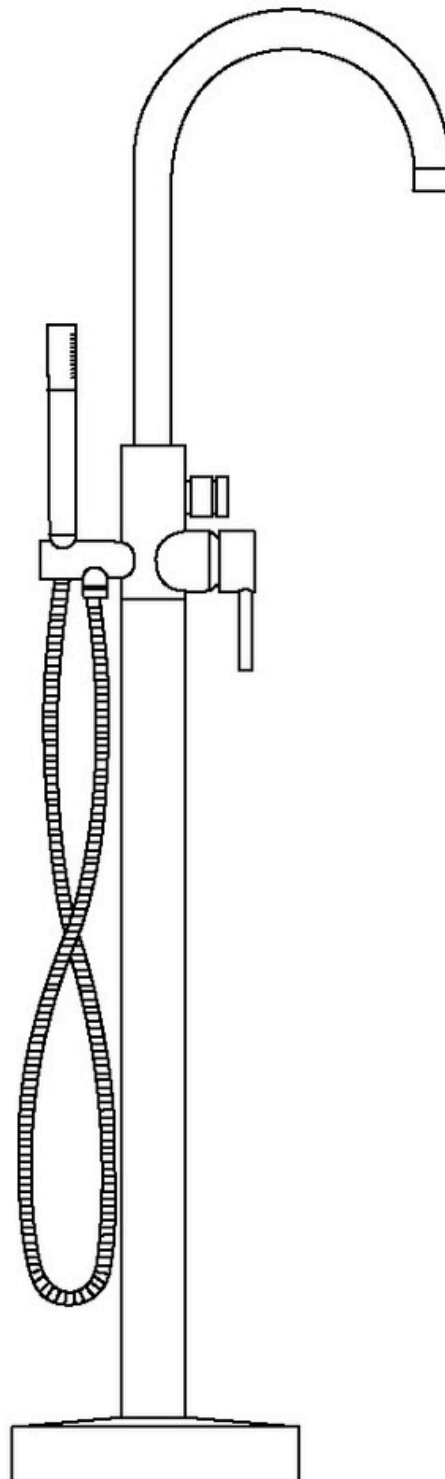

## **Dear Customers:**

**We would like to thank you for having chosen our shower pole series. To ensure that your new purchase maintains its efficiency over the years, we recommended that you follow the enclosed Installation Instructions carefully. At the same time, we support our best service to you!**

### **INSTALLATION:**

- 1. Mark out position of Shower Pole.**
- 2. Clean the tubes before installation**
- 3. Connect upper & lower tubes.**
- 4. Fit the fixed head to upper tube, align & screw with Allen screw.**
- 5. Connect water feed housing & flexible water feed tubes.**  
**Attach the Shower Pole to the water feed housing & the wall. Left tube to be connected with hot water, right with cold water.**
- 6. Check for water leaks.**

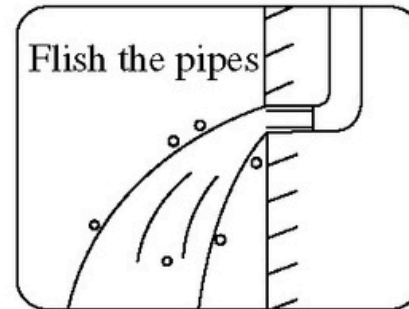

### **NOTE:**

**In order to get the best effect, please ask the professional worker to install.**

## **USING & CLEANING PROCEDURE:**

- 1. Check the Hydraulic Pressure first when lacking of flux (Best effect at 3-5 kg), then check the filter tip if any dirt blocked.**
- 2. Pay attention to the Logo on the faucet: left for cold water, right for hot water.**
- 3. Use a proprietary “daily shower cleaner remove” & a stiff brush.**

**Note: Ensure the cleaner/remover will not cause the damage to the Chrome decorative finish of showerhead.**

- 4. Using a stiff brush & a “stippling” motion clean the nozzles.**

**Note: The “stippling” motion will remove the external & internal (from the holes in the spray nozzles) staining.**



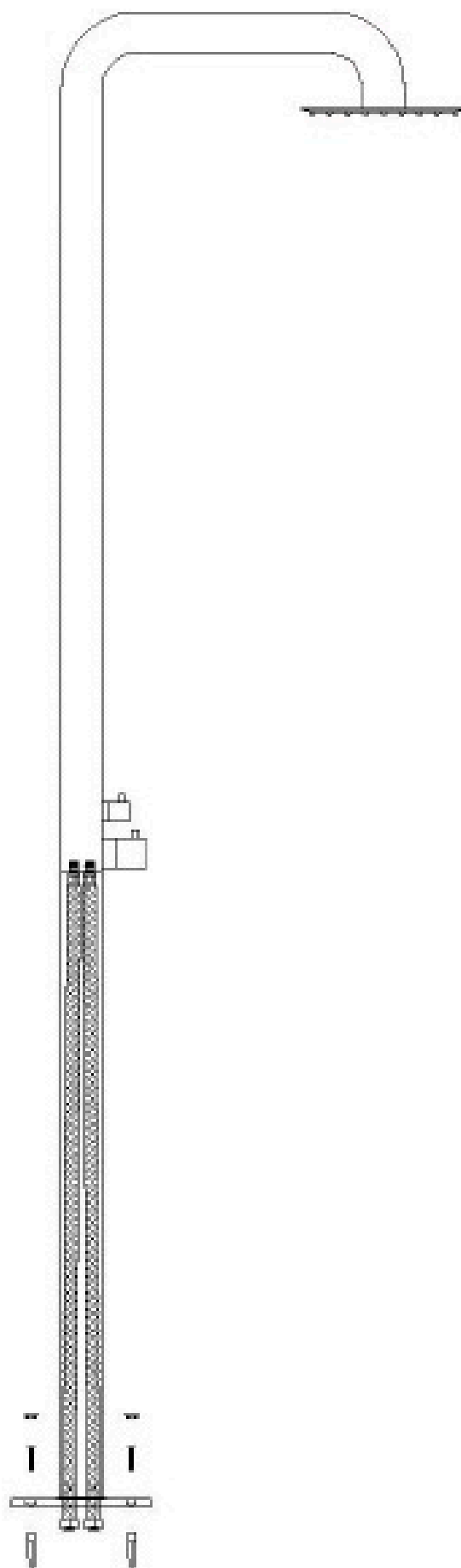

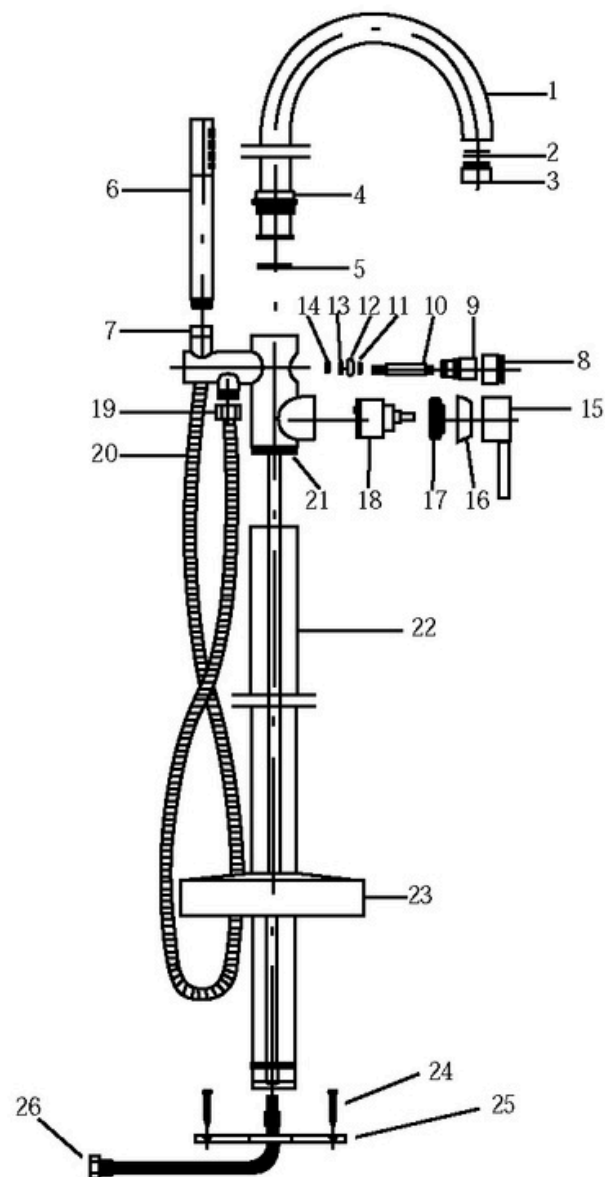

NO.	DESCRIPTION	QUANTITY	NO.	DESCRIPTION	QUANTITY
1	Upper Tube	1	14	M5 Nut	1
2	Gland	1	15	Control Handles	1
3	Tube Outlet	1	16	Controler Cover	1
4	Connect Nut	1	17	Cartridge Cover	1
5	Gland	1	18	Cartridge	1
6	Handset	1	19	Connector for Hose	1
7	Connector for Handset	1	20	Hose (1.5 M)	1
8	Divertor Handle	1	21	Hose Connect Nut	1
9	Knighthead	1	22	Lower Tube	1
10	Mandril	1	23	Fixed Seat Cover	1
11	M5 Brass Sheet	1	24	Fix Screw	2
12	Rubber Ball	1	25	Fix Seat	1
13	M5 Brass Sheet	1	26	Connecting Hose for Water Supply	2